

STANDARD PEAR BANDS

EC500
EP500
EF500

EC500			
PEAR BAND FOR COPPER PIPE			
PART NO.	PIPE DIA.	MATERIAL	ROD DIA.
EC500-032	32cu	25 x 1.6	M10
EC500-038	40cu	25 x 1.6	M10
EC500-051	50cu	25 x 1.6	M10
EC500-064	65cu	32 x 2.0	M10
EC500-076	80cu	32 x 2.0	M10
EC500-102	100cu	32 x 2.0	M10
EC500-127	125cu	32 x 2.0	M12
EC500-152	150cu	40 x 3.0	M12

FINISH: POLYESTER POWDER COATED - BROWN



EP500			
PEAR BAND FOR P.V.C PIPE			
PART NO.	PIPE DIA.	MATERIAL	ROD DIA.
EP500-38	32pvc	25 x 1.6	M10
EP500-43	38pvc	25 x 1.6	M10
EP500-48	40press	25 x 1.6	M10
EP500-60	50pvc	25 x 1.6	M10
EP500-76	65pvc	32 x 2.0	M10
EP500-89	80pvc	32 x 2.0	M10
EP500-115	100pvc	32 x 2.0	M10
EP500-140	125pvc	40 x 3.0	M12
EP500-165	150pvc	40 x 3.0	M12

FINISH: POLYESTER POWDER COATED - WHITE

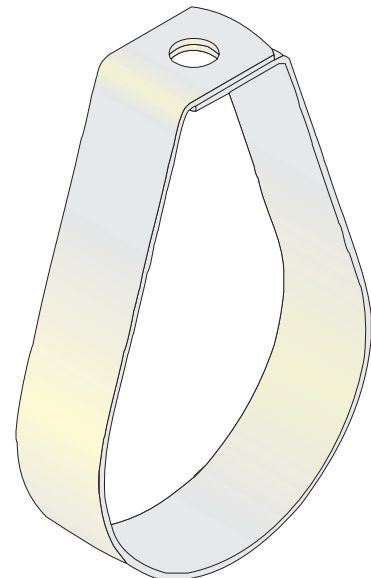

EF500			
PEAR BAND FOR STEEL PIPE			
PART NO.	PIPE DIA.	MATERIAL	ROD DIA.
EF500-027	20nb	25 x 1.6	M10
EF500-034	25nb	25 x 1.6	M10
EF500-043	32nb	25 x 1.6	M10
EF500-048	40nb	25 x 1.6	M10
EF500-060	50nb	25 x 1.6	M10
EF500-076	65nb	32 x 2.0	M12
EF500-089	80nb	32 x 2.0	M12
EF500-115	100nb	32 x 2.0	M12
EF500-140	125nb	40 x 3.0	M12
EF500-165	150nb	40 x 3.0	M12
EF500-220	200nb	50 x 3.0	M12

FINISH: GALVABOND

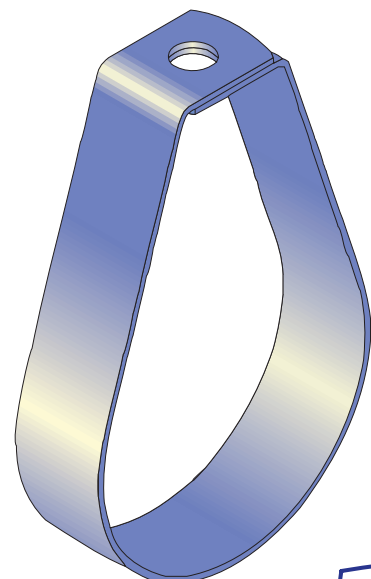

**STANDARD SIZES ONLY:
OTHER SIZES AVAILABLE ON REQUEST
FM APPROVAL PAIR BANDS AVAILABLE ON REQUEST**